



3-Axis Gimbal Rig for iPhone

iPhone 7 Plus / 7 / 6s Plus / 6s / 6 Plus / 6

iPhone SE / 5s / 5c / 5

# 1. Product Overview

\* The showing smartphone is only for reference

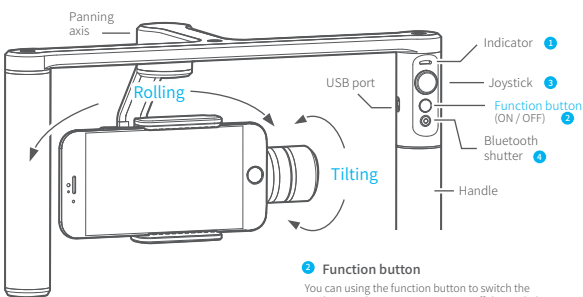
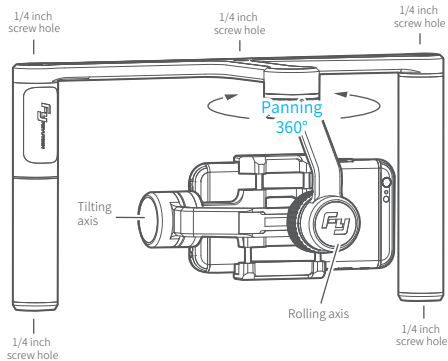

## 2 Function button

You can use the function button to switch the working mode, power on or power off the gimbal. Please refer to "Modes / Functions".

- ON:** Long press Function Button and release it until the green light is on.
- OFF:** Long press Function Button and release it until the red light changes from quick flashing to constant.

## 3 Joystick



Joystick	Camera lens
Up	Down
Down	Up
Left	Left
Right	Right

Indicator Status	Mode / Status
Blue light flashes once	Panning mode
Blue light flashes twice	Panning and Tilting mode
Blue light flashes for three times	Standby
Blue light constant on	Lock mode / Initializing
Blue light keeps flashing	Initialization failure / Malfunction
Red light flashes three times	Low battery
Red light keeps flashing	Entering standby / Entering power off

## 4 Bluetooth Shutter

Bluetooth name: FY\_SPGPlus\_xx

**Tips:** Make sure the volume "+" key of your iPhone can control the shooting.

After connecting with bluetooth , the button can be used as shutter function and the gimbal indicator will blinks a green light every 10 seconds.

### Connecting steps:

- Turn on the bluetooth of your iPhone.
- Connect your iPhone with "FY\_SPGPlus\_xx".
- It can act as a mobile phone camera shutter after a successful connection.

When you change your iPhone, please first shutdown Bluetooth of the previous one, then start Bluetooth pairing for the new one. 10 pieces of pairing info can be stored in this product.

**Bluetooth pairing information clear:** In boot-up state, long press the Bluetooth Shutter of the gimbal until the red light is on to clear all the bluetooth pairing info. After clearing, iPhone paired previously need to ignore "FY\_SPGPlus\_xx" first, then shutdown the Bluetooth of iPhone and reopen it to pair anew.

**Using App:** You can perform various settings and operations via specified smartphone app("FeiYu On") when the bluetooth is paired.

## 2. User Guide

### ⚠ Attention !

- (1) Please install the iPhone before powering on the gimbal
- (2) Please turn off the power when the gimbal is not in use, then remove the iPhone

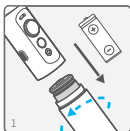

#### 1 Install the battery

Remove the handle and insert one 22650 battery into it.

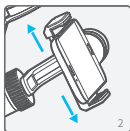

#### 2 Install the iPhone

Attach the iPhone by the quick-release adapter, and ensure it is secure.

▲ **Tips:** Please take off the protective casing of the iPhone before installation.

#### 3 Balance Adjustment

In order to achieve in a better performance of the gimbal, please try to adjust the iPhone installation to the best balance.



##### How to balance adjustment

T = Tight  
L = Loose

If the iPhone tilted to the right, then loose the knob ring, move the cross arm to the left, try to adjust to the best balance then tight it.

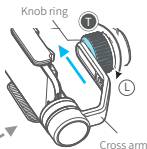
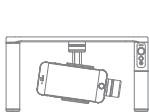
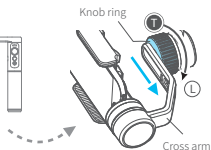
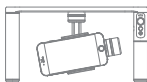

If the iPhone tilted to the left, then loose the knob ring, move the cross arm to the right, try to adjust to the best balance then tight it.

#### 4 Power on / off

**Power on:** Long press Function Button and release it until the green light is on.

**Power off:** Long press Function Button and release it until the red light changes from quick flashing to constant.

▲ **Attention:** Turn the gimbal on after ensuring the iPhone is secure.



If the battery power is too low, the red light will flash 3 times every 5 seconds. Please shut down the gimbal in time, and recharge or replace the battery.

### 3. Modes / Functions

#### Working Modes

##### Panning Mode

The phone can move to left or right smoothly along with the handheld moving.  
The tilting and rolling directions fixed.

\* Boot default mode: Panning mode

##### Panning and Tilting Mode

The phone can move to left or right and tilt up and down smoothly along with the handheld moving.  
The rolling directions fixed.

##### Lock Mode

The phone stays in its current orientation.  
The panning, tilting and rolling direction are all fixed.

#### Other Functions

##### Panorama

Convenient for the iPhone users to shot panorama photo.  
As shown, roll the gimbal slowly to the right (or left) 90°, the rolling axis automatically follow to the right (or left) is rotated by 90°.

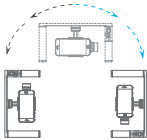

##### Reset

Reset the tilting axis of the gimbal to initial orientation and initial mode.

##### Standby

In standby mode, keep the gimbal in power-up state, the motor stops working, the indicator light flashes for three times, and single tap again the function button to wake up the gimbal.

#### Mode / Function Operation Instructions

Function Button	Function	Explanation
Single tap	Panning Mode / Lock Mode	Single tap to switch between panning mode and lock mode
Double tap	Panning and Tilting Mode	Under panning and tilting mode, single tap to switch to lock mode
Triple tap	Rotate 180°in horizontal	Make the lens rotate 180 °
Quadruple tap	Reset	Reset the tilting axis of the gimbal to initial orientation and initial mode
Long press until the red light flashes quickly	Standby	Single tap again to awake the gimbal, or triple tap to initialize the gimbal

### 4. Charging

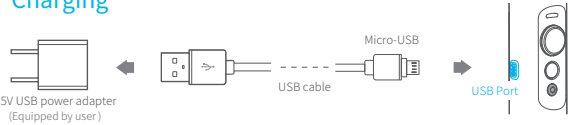

After power off, connect the USB cable to USB port, and connect with 5V USB power adapter (equipped by user) by USB cable .  
Or take out the battery, and use the corresponding charger to charge the battery (equipped by user).  
The red indicator light is on during charging, and green light is on after the battery is fully charged.

## 5. Gimbal Horizontal Angle Adjustment ( Initialize the gimbal )

The horizontal angle needs to be adjusted whenever the following situations happen to the gimbal

- (1) The tilt angle is not leveled with the horizontal surface.
- (2) The roll angle is not parallel to the horizontal surface.
- (3) Under lock mode, the panning angle drifts.

### Adjusting steps:

- (1) In boot-up state, long press the Function Button until the red light flashes quickly to enter standby status, the blue light will flash 3 times periodically.
- (2) Lay the gimbal on a static flat surface and triple tap the Function Button. Initialization is successful when the blue light changes from constant on to flashing 3 times periodically.

When the initialization failed, the LED indicator will flash quickly, repeat step (2) to reinitialize.

## 6. Parameters

Titling Angle	320°
Rolling Angle	100°
Panning Angle	360°
Titling Increments	2°/s ~ 75°/s
Panning Increments	3°/s ~ 150°/s
Usage time	8 Hours
Adaption	iPhone 7 Plus/7/6s Plus/6s/6 Plus/6/SE/5c/5s/5
Weight	518g (not including battery and iPhone)

### Package List

Product model	Quantity
SPG Plus	1
Batteries (Type:22650)	1
USB cable	1
Cold shoe mount	1
1/4 inch screw	1
User manual	1
Warranty card	1

### DISCLAIMER

Prohibit any user for any illegal purpose. Users will be responsible for all behaviors of purchase and use products.

The Company assumes no liability for any risks related to or resulting from the debug and use of this product (including the direct, indirect or third-party losses).

For any unknown sources of using, we will not be at any services.

The updating and changes of product firmware and program may cause changes in function descriptions in this user manual, please read the instructions carefully before upgrading the firmware and use the corresponding user manual.

You can get the latest user manual from the official website:  
[www.feiyu-tech.com](http://www.feiyu-tech.com)

Feiyu Tech reserves the right to amend this manual and the terms and conditions of use the product at any time.

### Attention

- Please correctly assemble the gimbal in accordance with the diagram.
- Please install the iPhone before powering on the gimbal.
- When the gimbal is not in use or placed on the table, please ensure it is powered off.



For more information, please visit our official website  
[www.feiyu-tech.com](http://www.feiyu-tech.com)  
Support Email: [service@feiyu-tech.com](mailto:service@feiyu-tech.com)



[www.feiyu-tech.com](http://www.feiyu-tech.com)