

G4 PRO

3-Axis Handheld Gimbal for iPhone

iPhone 6s Plus / 6s / 6 Plus / 6
iPhone 5s / 5C / 5 / 4s / 4

1. Product Overview

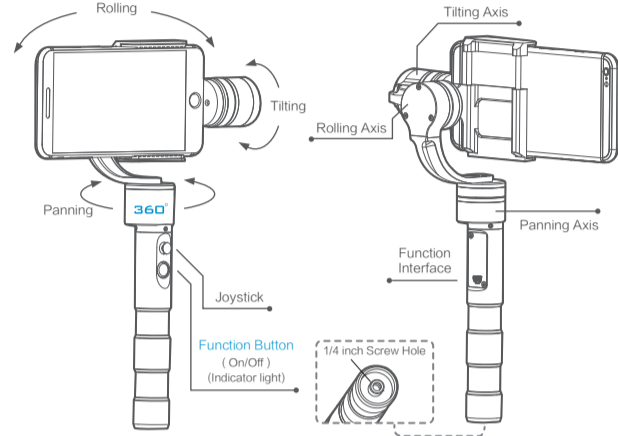

LED status	Explanation
Blue light flashes for three times	Full Power
Blue light flashes twice	Enough Power
Blue light flashes once	Low Power
Blue light keeps flashing	No Power

▲ When the red LED indicator light flashes in use, it means the gimbal is out-of-order

4. Operating

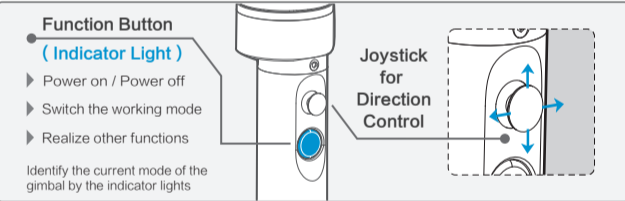

LED status	Mode / Status
Single flash	Panning mode
Double flashes	Panning and Tilting mode
Three flashes	Standby
Always on	Lock mode / Initialize the gimbal
Flash quickly	Rolling angle adjustment / Initialization failure / Malfunction

Mode	Controllable angle of joystick	Movement of joystick
Panning mode	Tilting angle	Up, Down
Panning and Tilting mode	Uncontrollable	Uncontrollable
Lock mode	Tilting and panning angle	Up, Down, Left, Right

Operating Instructions of Function Button

Operation	Function	Explanation
Single tap	Panning Mode / Lock Mode	Single tap to switch between panning mode and lock mode
Double tap	Panning and Tilting Mode	Under panning and tilting mode, single tap to switch to lock mode
Triple tap	Inversion Mode	It is possible to switch to other modes under inversion mode, triple tap again to exit inversion mode and reset
Quadruple tap	Reset	Reset the tilting axis of the gimbal to initial orientation and initial mode.
Tap button for six times	Rolling angle adjustment	Please refer to "Gimbal Horizontal Angle Adjustment" for operations
Long press for 1 second	Standby	Single tap again to awake the gimbal, or triple tap to initialize the gimbal
Long press for 3 seconds	Power off	

Working Modes

Panning Mode

The phone is allowed to pan left or right. Vertical tilts or rolls are restricted.

Panning and Tilting Mode

The phone is allowed to pan left or right and tilt up and down. Rolls are restricted.

Lock Mode

The phone stays in its current orientation. All panning, tilting and rolls are restricted.

Other Functions

Inversion Mode

Three working modes can be switched under inversion mode. After entering into the inversion mode, the gimbal automatically switches to the panning mode. Invert the gimbal, put the camera face down to capture the wonderful moments. The gimbal can restore to the boot-up state by consecutively pressing the function button for three times under inversion mode.

Manual Pulling Locking

After the gimbal being powered on for eight seconds, pull the tilting axis to the desired angle under non panning and tilting mode and wait for 0.5 second until the gimbal registers the new angle.

Reset

Reset the tilting axis of the gimbal to initial orientation and initial mode.

Standby

In standby model, keep the gimbal in power-up state, the motor stops working, the indicator light flashes for three times, and single tap again to wake the gimbal.

2. Accessories

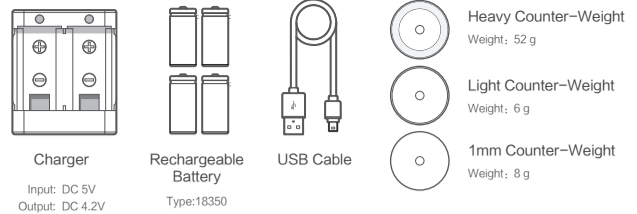

How to Charge

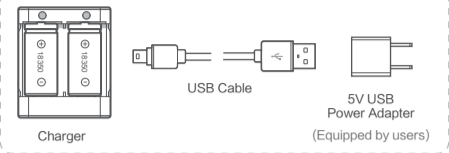

Connect the Mini-USB port of the USB cable with the charger, and the USB port with 5V USB power adapter.

3. User Guide

Attention! (1) Please install the iPhone before powering on the gimbal. (2) Please turn off the power when not in use.

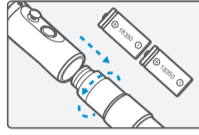

1 Install the batteries
Remove the power switch cap, and insert two 18350 batteries into the handle.

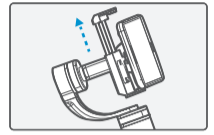

2 Install the phone
Attach the iPhone by the quick-release adapter, and ensure it is secure.
▲ Note: Please take off the protective casing of the phone before installation.

3 Adjust the phone position and install the counter-weight

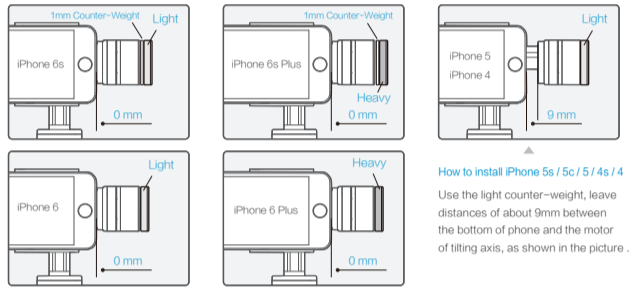

How to install iPhone6s / 6

Use the light counter-weight, attach the bottom of the phone to the motor of tilting axis.

How to install iPhone 6s Plus / 6 Plus

Use the heavy counter-weight, attach the bottom of the phone to the motor of tilting axis, as shown in the picture.

How to install iPhone 5s / 5c / 5 / 4s / 4

Use the light counter-weight, leave distances of about 9mm between the bottom of phone and the motor of tilting axis, as shown in the picture.

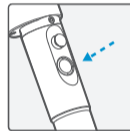

4 Power on / off

Power On: Single tap the function button, the gimbal shall be powered on after 2 seconds.
Power Off: Hold down the function button for three seconds to turn off the gimbal.

▲ Attention: Turn the gimbal on after ensuring the phone is secure.

5. Gimbal Horizontal Angle Adjustment

The horizontal angle needs to be adjusted whenever the following situations happen to the gimbal, user can adjust the horizontal angle by gimbal initialization and joystick.

- (1) The tilt angle is not leveled with the horizontal surface.
- (2) The roll angle is not parallel to the horizontal surface.
- (3) Under lock mode, the panning angle drifts.

Adjusting steps:

STEP 1 Initialize the gimbal

- (1) After powering the gimbal on, hold down the function button for one second to enter standby mode, and the LED indicator shall flash for three times;
- (2) Consecutively tap the function button for three times, LED indicator shall be always on, place the gimbal on a flat surface and keep it stationary;
- (3) When the initialization is completed, the LED indicator will flash for three times.

▲ When the initialization failed, the LED indicator will flash quickly, repeat step (2) & (3) to reinitialize.

After finished the **STEP 1**, the rolling angle still not parallel to the horizontal surface, you can use the joystick to adjust the rolling angle according to **STEP 2**.

STEP 2 Rolling angle adjustment

Tap button for six times for roll angle adjustment, the tilt and roll angle restore to the horizontal status. Under the roll angle adjustment state, move the joystick to the left or to the right to adjust the roll angle, single tap again to save the setting and exit after adjusting.

6. Parameters

Vertical Tilting Angle	320°
Rolls Angle	100°
Horizontal Panning Angle	360°
Tilting Increments	2° /s ~ 75° /s
Panning Increments	3° /s ~ 150° /s
Usage time	4 Hours
Adaption	iPhone 6s Plus / 6s / 6 Plus / 6 / 5c / 5s / 5 / 4s / 4
Weight	315g (not including batteries, phone, or counter-weight) Heavy Counter-weight 52g Light Counter-weight 6g

DISCLAIMER

G4 Pro 3-Axis handheld gimbal for iPhone is an excellent camera stabilizer, lightweight and portable. Prohibit any user for any illegal purpose. Users will be responsible for all behaviors of purchase and use products.

The Company assumes no liability for any risks related to or resulting from the debug and use of this product (including the direct, indirect or third-party losses).

For any unknown sources of using, we will not be at any services.

Feiyu Tech reserves the right to amend this manual and the terms and conditions of use the gimbal at any time.

Attention

- Please correctly assemble the gimbal in accordance with the diagram.
- Please install the camera before powering on the gimbal.
- Please charge the battery with the standard charger.
- When the gimbal is not in use or placed on the table, please ensure it is powered off.

Scan and keep an eye on FY



Please visit the official website of Feiyu Tech to get related information: www.feiyu-tech.com
Support email: service@feiyu-tech.com